

Silent Check Valve (H71X-16Q), PN16

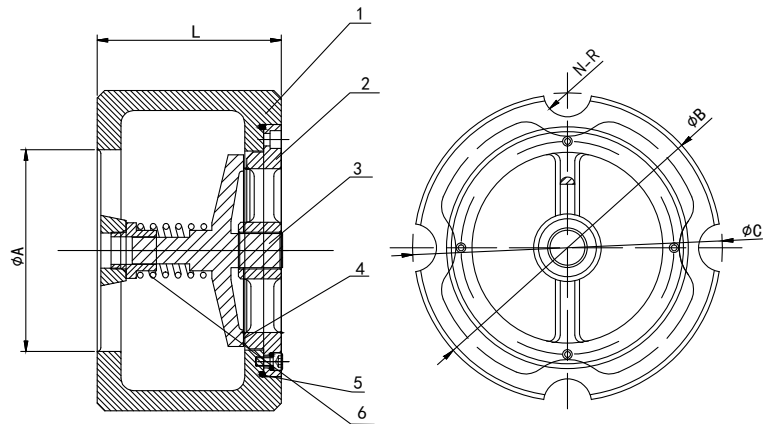

H71X-16Q

- Connection Ends: Flange to BS EN 1092-2
- Working Pressure: PN16
- Working temperature: 0°C - 80°C
- Coating: Fusion Bonded Epoxy Coating Complies with ANSI/AWWA C550
- Applications Potable Water, Water Distribution Service & Feedlines Sewage Disposal, Irrigation and Fire Protection Pipe System etc.



MATERIAL SPECIFICATION

Part No.	Part	Standard Specification
1	Body	QT400
2	Guide	SS316
3	Disc	SS316
4	Rubbering	EPDM
5	Seat	EPDM
6	Spring	Stainless Steel

Note: For special material request other than standard specification, please indicate clearly on the inquiry or order list.

DN		PN	Dimensions(mm)					
Inch	mm		L	A	B	C	N	R
2"	50	16	67	59	108	120	4	R10
2.5"	65	16	73	80	127	140	4	R10
3"	80	16	79	84	146	148	8	R10
4"	100	16	102	112	174	180	8	R10
6"	150	16	140	164	248	243	8	R12.5
8"	200	16	165	216	340	298	12	R12.5