

## MECH FLOW SUPPLIES



Malleable Iron  
Pipe Fittings



Ductile Iron  
Grooved Fittings  
and Couplings



Valves



Cast Bronze  
Fittings



Electrical  
Power Fittings



Malleable Iron  
Pipe Clamps



Ductile Iron Pipe Fittings  
Cast Iron Pipe Fittings



Pipe Nipples



### JINAN MEIDE CASTING CO., LTD.

Address: Meide Industrial Science and Technology City,  
Industrial Park Pingyin, Jinan, China 250400

Phone: (86)531 87879384 87885036 87885067

Fax: (86)531 87879387

Email: [info@meide-casting.com](mailto:info@meide-casting.com)

[Http://www.meide-casting.com](http://www.meide-casting.com)



UPDATED 05/2022



# 14" - 32" Grooved Fittings & Couplings

To Provide **Safe & Reliable** Products and **Smart & Complete**  
Solutions for Clients in Fluid Conveying Industry Across the Globe.





# Grooved Fittings & Couplings

Material: ASTM A536, GRADE 65-45-12, QT450-10  
 Threads: ASME B1.20.1, ISO 7-1, GB 7306  
 Size Available: 14"-32"



## 1N Standard Flexible Coupling

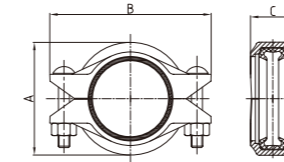

Nominal Size mm/in	Pipe O.D mm/in	Working Pressure PSI/MPa	Max. End Load kN/Lbs	Pipe End Separation mm/in	Dimensions			Bolt Size
					A mm/in	B mm/in	C mm/in	No.-Size mm
350 14	355.6 14.000	300 2.07	205.5/46220	0-3.2 0-0.13	402 15.83	493 19.41	72 2.83	3-7/8×140 3-M22×140
400 16	406.4 16.000	300 2.07	268.4/60370	0-3.2 0-0.13	458 18.03	547 21.54	72 2.85	3-7/8×140 3-M22×140
450 18	457.2 18.000	300 2.07	262.5/59060	0-3.2 0-0.13	505 19.88	598 23.54	78 3.07	3-7/8×140 3-M22×140
500 20	508.0 20.000	300 2.07	324.1/72910	0-3.2 0-0.13	550 21.65	648 25.51	78 3.07	4-7/8×140 4-M22×140
600 24	609.6 24.000	300 2.07	466.7/104990	0-3.2 0-0.13	662 26.06	774 30.47	78 3.07	4-1X140

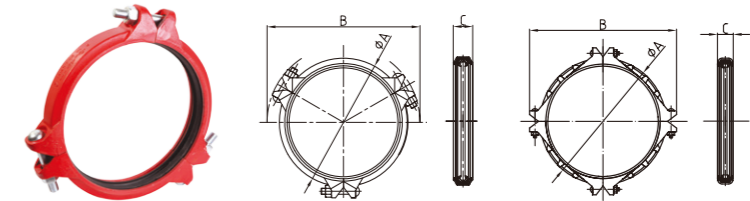

## 1G Standard Rigid Coupling

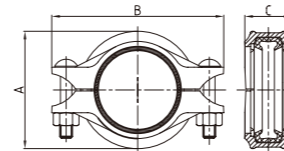

Nominal Size mm/in	Pipe O.D mm/in	Working Pressure PSI/MPa	Max. End Load kN/Lbs	Pipe End Separation mm/in	Dimensions			Bolt Size
					A mm/in	B mm/in	C mm/in	No.-Size mm
350 14	355.6 14.000	300 2.07	205.5/46220	0-3.2 0-0.13	415 16.34	510 20.08	72 2.84	3-7/8X140 3-M22X140
400 16	406.4 16.000	300 2.07	268.4/60370	0-3.2 0-0.13	468 18.43	575 22.64	72 2.84	3-7/8X140 3-M22X140
450 18	457.2 18.000	225 1.6	262.5/59060	0-3.2 0-0.13	508 20	608 23.94	78 3.07	3-7/8X140 3-M22X140
500 20	508.0 20.0	225 1.6	324.1/72910	0-3.2 0-0.13	563 22.17	660 25.98	78 3.07	4-7/8X140 4-M22X140
600 24	609.6 24.000	225 1.6	466.7/104990	0-3.2 0-0.13	668 26.30	772 30.40	78 3.07	4-1X140
700 28	711.2 28	225 1.6	635/142900	8-12 0.31-0.47	798 31.42	960 37.80	133 5.24	6-11/2X53/4
800 32	812.8 32	225 1.6	830/186700	8-12 0.31-0.47	900 35.43	1058 41.65	133 5.24	6-11/2X53/4

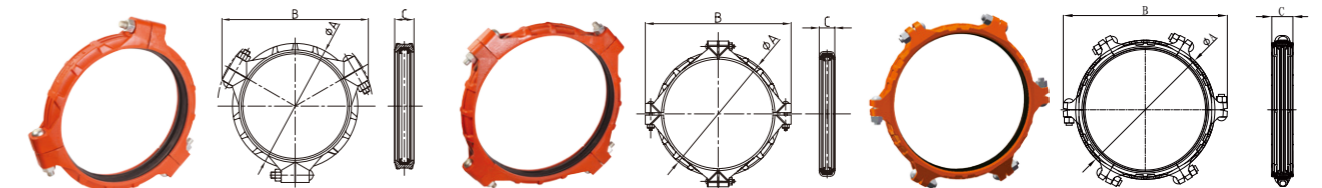

### 90° Elbow

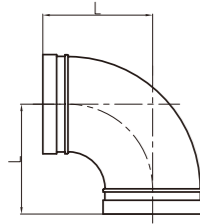

Nominal Size mm/in	Pipe O.D mm/in	Working Pressure PSI/MPa	Dimensions L mm/in	Certificate
350 14	355.6 14.000	300 2.07	280 11.02	UL
400 16	406.4 16.000	300 2.07	305 12.00	UL
450 18	457.2 18.000	300 2.07	394 15.50	UL
500 20	508.0 20.000	300 2.07	438 17.25	UL
600 24	609.6 24.000	300 2.07	508 20.00	UL

### 45° Elbow

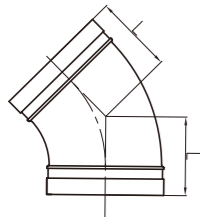

Nominal Size mm/in	Pipe O.D mm/in	Working Pressure PSI/MPa	Dimensions L mm/in	Certificate
350 14	355.6 14.000	300 2.07	152 6.00	UL
400 16	406.4 16.000	300 2.07	184 7.25	UL
450 18	457.2 18.000	300 2.07	203 8.00	UL
500 20	508.0 20.000	300 2.07	229 9.00	UL
600 24	609.6 24.000	300 2.07	280 11.00	UL

### 130R Reducing Tee

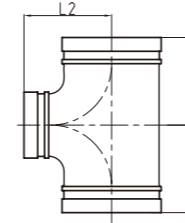

Nominal Size mm/in	Pipe O.D mm/in	Working Pressure PSI/MPa	Dimensions L 1 mm/in SW	Dimensions L 2 mm/in SW	Certificate
350×150 14×6	355.6×168.3 14.000×6.625	300 2.07	279 (SW) 10.98	238 (SW) 9.37	—
350×250 14×10	355.6×273.0 14.000×10.750	300 2.07	279 (SW) 10.98	257 (SW) 10.12	UL
350×300 14×12	355.6×323.9 14.000×12.750	300 2.07	279 (SW) 10.98	270 (SW) 10.63	UL
400×150 16×6	406.4×168.3 16.000×6.625	300 2.07	305 (SW) 12.01	264 (SW) 10.39	—
400×200 16×8	406.4×219.1 16.000×8.625	300 2.07	305 (SW) 12.01	273 (SW) 10.75	—
400×250 16×10	406.4×273.0 16.000×10.750	300 2.07	305 (SW) 12.01	283 (SW) 11.14	—
400×300 16×12	406.4×323.9 16.000×12.750	300 2.07	305 (SW) 12.01	295 (SW) 11.61	—
400×350 16×14	406.4×355.6 16.000×14.000	300 2.07	305 (SW) 12.01	305 (SW) 12.01	—
450×150 18×6	457.2×168.3 18.000×6.625	300 2.07	343 (SW) 13.50	298 (SW) 11.73	—
450×200 18×8	457.2×219.1 18.000×8.625	300 2.07	343 (SW) 13.50	298 (SW) 11.73	—
450×250 18×10	457.2×273.0 18.000×10.750	300 2.07	343 (SW) 13.50	308 (SW) 12.13	—
450×300 18×12	457.2×323.9 18.000×12.750	300 2.07	343 (SW) 13.50	321 (SW) 12.64	—
450×350 18×14	457.2×355.6 18.000×14.000	300 2.07	343 (SW) 13.50	330 (SW) 12.99	—
450×400 18×16	457.2×406.4 18.000×16.000	300 2.07	343 (SW) 13.50	330 (SW) 12.99	—
500×150 20×6	508.0×168.3 20.000×6.625	300 2.07	381 (SW) 15.00	324 (SW) 12.76	—
500×200 20×8	508.0×219.1 20.000×8.625	300 2.07	381 (SW) 15.00	324 (SW) 12.76	—
500×250 20×10	508.0×273.0 20.000×10.750	300 2.07	381 (SW) 15.00	333 (SW) 13.11	—
500×300 20×12	508.0×323.9 20.000×12.750	300 2.07	381 (SW) 15.00	346 (SW) 13.62	—
500×350 20×14	508.0×355.6 20.000×14.000	300 2.07	381 (SW) 15.00	356 (SW) 14.02	—
500×400 20×16	508.0×406.4 20.000×16.000	300 2.07	381 (SW) 15.00	356 (SW) 14.02	—
500×450 20×18	508.0×457.2 20.000×18.000	300 2.07	381 (SW) 15.00	368 (SW) 14.49	—
600×150 24×6	609.6×168.3 24.000×6.625	300 2.07	432 (SW) 17.01	384 (SW) 15.12	—
600×200 24×8	609.6×219.1 24.000×8.625	300 2.07	432 (SW) 17.01	384 (SW) 15.12	—
600×250 24×10	609.6×273.0 24.000×10.750	300 2.07	432 (SW) 17.01	384 (SW) 15.12	—
600×300 24×12	609.6×323.9 24.000×12.750	300 2.07	432 (SW) 17.01	397 (SW) 15.63	—
600×350 24×14	609.6×355.6 24.000×14.000	300 2.07	432 (SW) 17.01	406 (SW) 15.98	—
600×400 24×16	609.6×406.4 24.000×16.000	300 2.07	432 (SW) 17.01	406 (SW) 15.98	—
600×450 24×18	609.6×457.2 24.000×18.000	300 2.07	432 (SW) 17.01	419 (SW) 16.50	—
600×500 24×20	609.6×508.0 24.000×20.000	300 2.07	432 (SW) 17.01	432 (SW) 17.01	—

Segmental sizes are made of carbon steel pipe or fabricated from wrought carbon steel. Contact manufacturer for details. (SW) = Carbon Steel Segmentally Welded

# 130

Tee

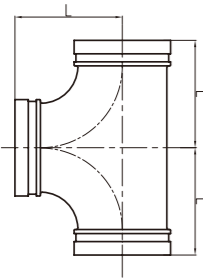

Nominal Size mm/in	Pipe O.D mm/in	Working Pressure PSI/MPa	Dimensions L mm/in	Certificate
350 14	355.6 14.000	300 2.07	280 11.02	UL
400 16	406.4 16.000	300 2.07	305 12.00	UL
450 18	457.2 18.000	300 2.07	342 13.46	UL
500 20	508.0 20.000	300 2.07	381 15.00	UL
600 24	609.6 24.000	300 2.07	432 17.01	UL

# 180

Cross

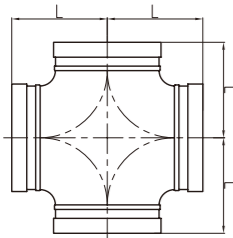

Nominal Size mm/in	Pipe O.D mm/in	Working Pressure PSI/MPa	Dimensions L mm/in
350 14	355.6 14.000	300 2.07	279 10.98
400 16	406.4 16.000	300 2.07	305 12.01
450 18	457.2 18.000	300 2.07	343 13.5
500 20	508.0 20.000	300 2.07	381 15.00
600 24	609.6 24.000	300 2.07	432 17.01

Segmental sizes are made of carbon steel pipe or fabricated from wrought carbon steel. Contact manufacturer for details.

# 230

Grooved Eccentric Reducer

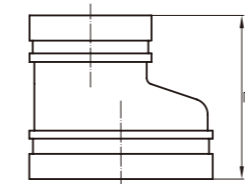

Nominal Size mm/in	Pipe O.D mm/in	Working Pressure PSI/MPa	Dimensions L mm/in	Certificate
350X150 14X6	355.6X168.3 14.000X6.625	300 2.07	330 12.99	—
350X200 14X8	355.6X219.1 14.000X8.625	300 2.07	330 12.99	UL
350X250 14X10	355.6X273.0 14.000X10.750	300 2.07	330 12.99	UL
350X300 14X12	355.6X323.9 14.000X12.750	300 2.07	330 12.99	UL
400X200 16X8	406.4X219.1 16.000X8.625	300 2.07	356 14.02	—
400X250 16X10	406.4X273.0 16.000X10.750	300 2.07	356 14.02	—
400X300 16X12	406.4X323.9 16.000X12.750	300 2.07	356 14.02	—
400X350 16X14	406.4X355.6 16.000X14.000	300 2.07	356 14.02	—
450X150 18X6	457.2X168.3 18.000X6.625	300 2.07	381 15.00	—
450X250 18X10	457.2X273.0 18.000X10.750	300 2.07	381 15.00	—
450X300 18X12	457.2X323.9 18.000X12.750	300 2.07	381 15.00	—
450X350 18X14	457.2X355.6 18.000X14.000	300 2.07	381 15.00	—
450X400 18X16	457.2X406.4 18.000X16.000	300 2.07	381 15.00	—
500X300 20X12	508.0X323.9 20.000X12.750	300 2.07	508 20.00	—
500X350 20X14	508.0X355.6 20.000X14.000	300 2.07	508 20.00	—
500X400 20X16	508.0X406.4 20.000X16.000	300 2.07	508 20.00	—
500X450 20X18	508.0X457.2 20.000X18.000	300 2.07	508 20.00	—
600X400 24X16	609.6X406.4 24.000X16.000	300 2.07	508 20.00	—
600X450 24X18	609.6X457.2 24.000X18.000	300 2.07	508 20.00	—
600X500 24X20	609.6X508.0 24.000X20.000	300 2.07	508 20.00	—

Segmental sizes are made of carbon steel pipe or fabricated from wrought carbon steel. Contact manufacturer for details.

## 240

### Grooved Concentric Reducer

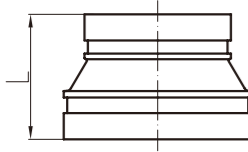

Nominal Size mm/in	Pipe O.D mm/in	Working Pressure PSI/MPa	Dimensions L mm/in SW	Certificate
350X150 14X6	355.6X168.3 14.000X6.625	300 2.07	330 (SW) 12.99	—
350X200 14X8	355.6X219.1 14.000X8.625	300 2.07	330 (SW) 12.99	UL
350X250 14X10	355.6X273.0 14.000X10.750	300 2.07	330 (SW) 12.99	UL
350X300 14X12	355.6X323.9 14.000X12.750	300 2.07	330 (SW) 12.99	UL
400X200 16X8	406.4X219.1 16.000X8.625	300 2.07	356 (SW) 14.02	—
400X250 16X10	406.4X273.0 16.000X10.750	300 2.07	356 (SW) 14.02	—
400X300 16X12	406.4X323.9 16.000X12.750	300 2.07	356 (SW) 14.02	—
400X350 16X14	406.4X355.6 16.000X14.000	300 2.07	356 (SW) 14.02	—
450X150 18X6	457.2X168.3 18.000X6.625	300 2.07	381 (SW) 15.00	—
450X250 18X10	457.2X273.0 18.000X10.750	300 2.07	381 (SW) 15.00	—
450X300 18X12	457.2X323.9 18.000X12.750	300 2.07	381 (SW) 15.00	—
450X350 18X14	457.2X355.6 18.000X14.000	300 2.07	381 (SW) 15.00	—
450X400 18X16	457.2X406.4 18.000X16.000	300 2.07	381 (SW) 15.00	—
500X300 20X12	508.0X323.9 20.000X12.750	300 2.07	508 (SW) 20.00	—
500X350 20X14	508.0X355.6 20.000X14.000	300 2.07	508 (SW) 20.00	—
500X400 20X16	508.0X406.4 20.000X16.000	300 2.07	508 (SW) 20.00	—
500X450 20X18	508.0X457.2 20.000X18.000	300 2.07	508 (SW) 20.00	—
600X400 24X16	609.6X406.4 24.000X16.000	300 2.07	508 (SW) 20.00	—
600X450 24X18	609.6X457.2 24.000X18.000	300 2.07	508 (SW) 20.00	—
600X500 24X20	609.6X508.0 24.000X20.000	300 2.07	508 (SW) 20.00	—

Segmental sizes are made of carbon steel pipe or fabricated from wrought carbon steel. Contact manufacturer for details. (SW) = Carbon Steel Segmentally Welded

## 300

### Cap



Nominal Size mm/in	Pipe O.D mm/in	Working Pressure PSI/MPa	Dimensions L mm/in SW	Certificate
350 14	355.6 14.000	300 2.07	165 (SW) 6.50	UL
400 16	406.4 16.000	300 2.07	178 (SW) 7.00	—
450 18	457.2 18.000	300 2.07	203 (SW) 8.00	—
500 20	508.0 20.000	300 2.07	229 (SW) 9.00	—
600 24	609.6 24.000	300 2.07	267 (SW) 10.50	—

Segmental sizes are made of carbon steel pipe or fabricated from wrought carbon steel. Contact manufacturer for details. (SW) = Carbon Steel Segmentally Welded

## 321

### PN16 Grooved Flange

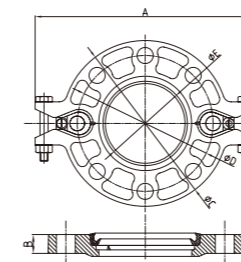

Nominal Size mm/in	Pipe O.D mm/in	Working Pressure PSI/MPa	Dimensions					Bolt/Nut	
			A mm/in	B mm/in	C mm/in	D mm/in	E mm/in	No.-SIZE mm	
350 14	355.6 12.750	300 2.07	580 22.83	30 1.18	520 20.47	470 18.50	350.6 13.80	—	16-M24
400 16	406.4 16.000	300 2.07	630 24.80	32 1.26	580 22.83	525 20.67	401.5 15.81	—	16-M27
450 18	457.2 18.000	300 2.07	693 27.28	36 1.42	640 25.20	585 23.03	452.2 17.80	—	20-M27
500 20	508.0 20.000	300 2.07	770 30.31	36 1.42	715 28.15	650 25.59	503 19.80	—	20-M30
600 24	609.6 24.000	300 2.07	895 35.24	40 1.57	840 33.07	770 30.31	601.6 23.69	—	20-M33

### 321A ANSI 125/150 Grooved Flange

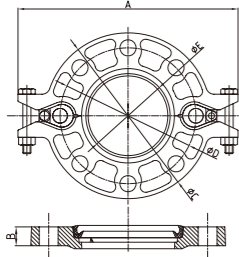

Nominal Size mm/in	Pipe O.D mm/in	Working Pressure PSI/MPa	Dimensions					Bolt/Nut	
			A mm/in	B mm/in	C mm/in	D mm/in	E mm/in	No.-SIZE mm	
350 14	355.6 12.750	300 2.0	590 23.22	37 1.44	535 21.00	476.3 18.75	350.6 13.80	—	12-1
400 16	406.4 16.000	300 2.0	650 25.59	37 1.44	595 23.50	539.8 21.25	401.5 15.81	—	16-1
450 18	457.2 18.000	300 2.0	690 27.17	40 1.56	635 25.80	577.8 22.75	452.2 17.80	—	16-11/8
500 20	508.0 20.000	300 2.0	765 30.12	43 1.69	700 27.50	635 25.00	503 19.80	—	20-11/8
600 24	609.6 24.000	300 2.0	875 34.45	49 1.94	815 32.00	749.3 29.50	601.6 23.69	—	20-11/4

### 321G PN16 Adaptor Flange

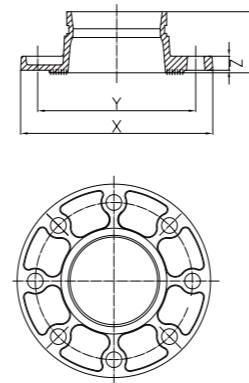

Nominal Size mm/in	Pipe O.D mm/in	Working Pressure PSI/MPa	Dimensions				Bolt/Nut	
			L mm/in	X mm/in	Y mm/in	Z mm/in	No.-SIZE mm	
350 14	377.0 14.843	225 1.6	100 3.937	520 20.47	470 18.50	25 1.00	16-M24	
400 16	426.0 16.772	225 1.6	110 4.331	580 22.83	525 20.67	27 1.06	16-M27	
450 18	480 18.897	225 1.6	115 4.528	640 25.196	585 23.03	20 0.787	20-M27	

### 321E BS. TABLE 'E' Grooved Flange

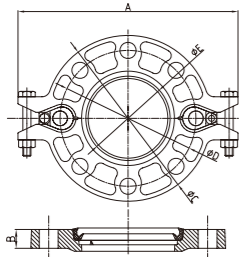

Nominal Size mm/in	Pipe O.D mm/in	Working Pressure PSI/MPa	Dimensions					Bolt/Nut	
			A mm/in	B mm/in	C mm/in	D mm/in	E mm/in	No.-SIZE mm	
350 14	355.6 12.750	200 1.4	580 22.83	32 1.26	527 20.75	470 18.50	350.6 13.80	—	12-7/8
400 16	406.4 16.000	200 1.4	630 24.80	32 1.26	578 22.76	521 20.51	401.5 15.81	—	12-7/8
450 18	457.2 18.000	200 1.4	693 27.28	36 1.42	641 25.24	584 23.00	452.2 17.80	—	16-7/8
500 20	508.0 20.000	200 1.4	770 30.31	38 1.50	705 27.76	641 25.24	503 19.80	—	16-7/8
600 24	609.6 24.000	200 1.4	880 34.65	42 1.65	826 32.52	756 29.76	601.6 23.69	—	16-11/8

### 321GA ANSI 125/150 Adaptor Flange Class 125/150

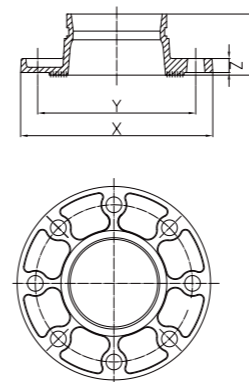

Nominal Size mm/in	Pipe O.D mm/in	Working Pressure PSI/MPa	Dimensions				Bolt/Nut		Certificate
			L mm/in	X mm/in	Y mm/in	Z mm/in	No.-SIZE mm		
350 14	355.6 12.750	300 2.0	127 5.00	535 21.00	476.3 18.75	37 1.44	12-1	UL	
400 16	406.4 16.000	300 2.0	127 5.00	595 23.50	539.8 21.25	37 1.44	16-1	UL	
450 18	457.2 18.000	300 2.0	140 5.50	642 25.28	577.8 22.75	40 1.56	16-11/8	UL	
500 20	508.0 20.000	300 2.0	152 6.00	700 27.50	635 25.00	43 1.69	20-11/8	UL	
600 24	609.6 24.000	300 2.0	152 6.00	815 32.00	749.3 29.50	49 1.94	20-11/4	UL	